

Before proceeding with the installation carefully read the instructions and consider whether one possesses the necessary technical skills and workshop tools to complete the installation properly. Otherwise, any BMW Motorcycle Retailer will be glad to install this accessory.

Attention



Special notes and cautionary measures which can prevent damage to the accessory or motorcycle.

Note:



Tips for facilitation of operation, control and adjustment, as well as maintenance work.

PARTS LIST

| <u>Index</u> | <u>Description</u> | <u>Part No.</u> | <u>Qty.</u> |
|----------------|-----------------------------|-----------------|-------------|
| 1 | Front Fender Tip | | 1 |
| BAG 513 | | | |
| 2 | Screw, M5- .8 x 8 Stainless | 51-516508-000 | 2 |
| 3 | Washer, Flat #10 x 5/8 | 49-490105-000 | 2 |
| 4 | Template and Instructions | 10-110647-000 | 1 |

Tools Needed:

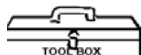

Scissors (for template)
Masking Tape
5mm and 3mm Hex Wrench
Awl
Hand Drill with 1/8" (3mm) and 1/4" (6.5mm) Drill Bit
Rat Tail File



DEALERS and RIDERS- This quality Fender Tip is cast aluminum hand polished and chromed plated to a brilliant finish. Slight variations in shape may result from the hand process. Each tip was carefully inspected and the center of the tip marked using a K1200 LT fender fixture. Please follow the installation instructions and check before you drill.

Thank you, ZTechnik

PREPARATION

The unique, hidden screw mount requires the fender to be removed for installation of the Fender Tip.

1. Remove the 4 screws holding the front fender. The side screws are held captive with a collar leave collar in place, retain screws. **(5mm hex wrench). Figure 1.**
2. Locate the Drill Template, form 10-110648-000. Cutout template on outside line, and carefully follow the instructions that follow.



Do not attempt to drill the holes without a Drill Template.

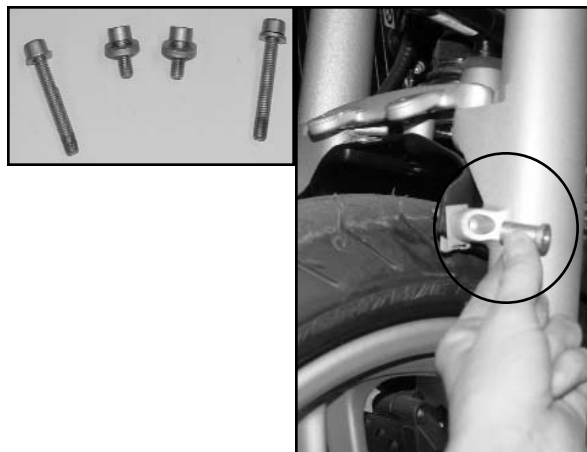



Figure 1.

LOCATE ALIGNMENT POINT ON FENDER TO ALIGN TEMPLATE

1. Stand fender on end and place Fender Tip on Fender. Gently press left and right edges against fender. Let Tip find its center point.

2. Place a piece of masking tape on fender to extend the alignment mark from FENDER TIP to the fender. **Figure 2. (Tape)**

 The template is drafted to accurately locate center to drill holes. You can check this by lining the printed side of template to the back side of the Fender Tip. Slight variations in the length of the template from hole to end do not affect the drill location.



Left and right underside of tip should be against fender edge when tip is correctly mounted.

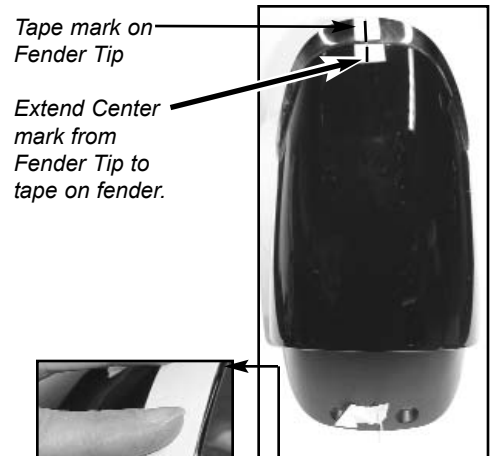

Tape mark on Fender Tip
Extend Center mark from Fender Tip to tape on fender.

Figure 2

REMOVE TIP, ATTACH TEMPLATE

3. Remove Fender Tip. Refer to Figure 3 and carefully tape template to leading edge of fender.

 Make certain the alignment marks are aligned.



Figure 3

NOT THIS. Do not allow template to ride up on left and right sides.

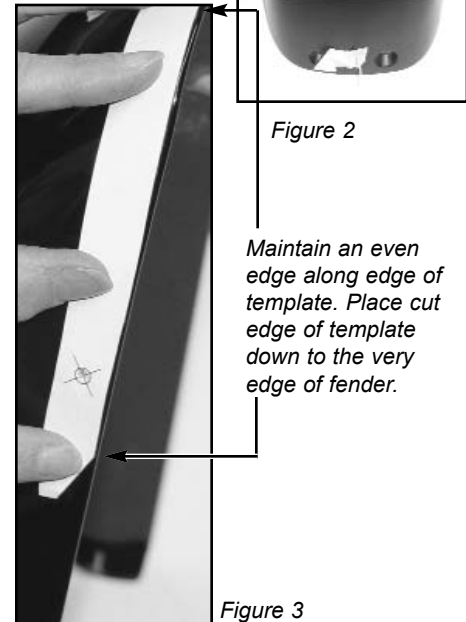

Maintain an even edge along edge of template. Place cut edge of template down to the very edge of fender.

Figure 3

DRILL

4. Mark center of drill hole. Remove Template. **Figure 4. (Awl)**

6. Drill fender over block of wood in a work area where you can keep fender steady. Drill a 1/8" pilot hole followed by a 1/4" hole. **Figure 5. (Drill, 1/8" and 1/4" Drill Bit).**

 Do not scratch fender. Mask the area if necessary.

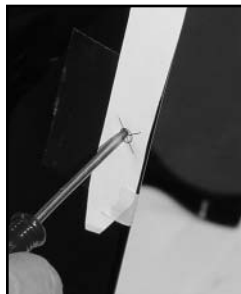

Figure 4

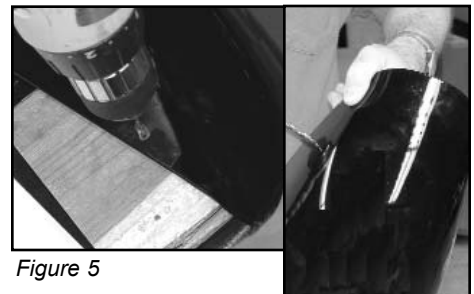

Figure 5

7. Plastic build up on outside surface of fender will interfere with the fit of the fender tip. Avoid this build up by deburring the holes.

8. Check fit of tip, if necessary open hole as needed. **(Rat Tail File) Figure 6.**

9. Loosely install Tip with the Flat Washer against inside of fender and the M5 Stainless Screws. Tighten Screws firmly. **Figure 7. (5mm Hex Wrench)**

10. Re-install fender.



Figure 6



Figure 7

Washer against Fender

Z3150 K1200 LT Front Fender Tip Template

Control scale: This line should measure 3"

