

PARTS LIST

Index	Description	Qty.
1	Muffler Packing	1
2	Strap, Stainless	1
3	Pop Rivets, Stainless	7

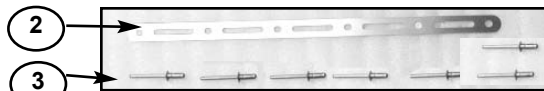
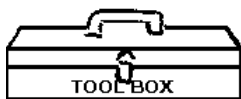

Figure 1

NOTE: Your dealer has the necessary tools and knowledge to perform this repack procedure safely and efficiently.



- Exhaust Spring Puller (not pictured)
- Center Punch
- Drift Punch, 3/16" and 1/8" Shank
- Cold Chisel, 3/8" wide, sharp
- Drill Electric or Air
- Drill Bit for Rivet Removal or 1/8" Drill Bit and 1/4" Drill Bit
- Needle Nose Pliers
- Ball Peen Hammer
- Air Powered Pop Rivet Tool
- Rubber Mallet
- Old Towel or Rubber Mat (work surface)

We recommended wearing safety glasses during installation.

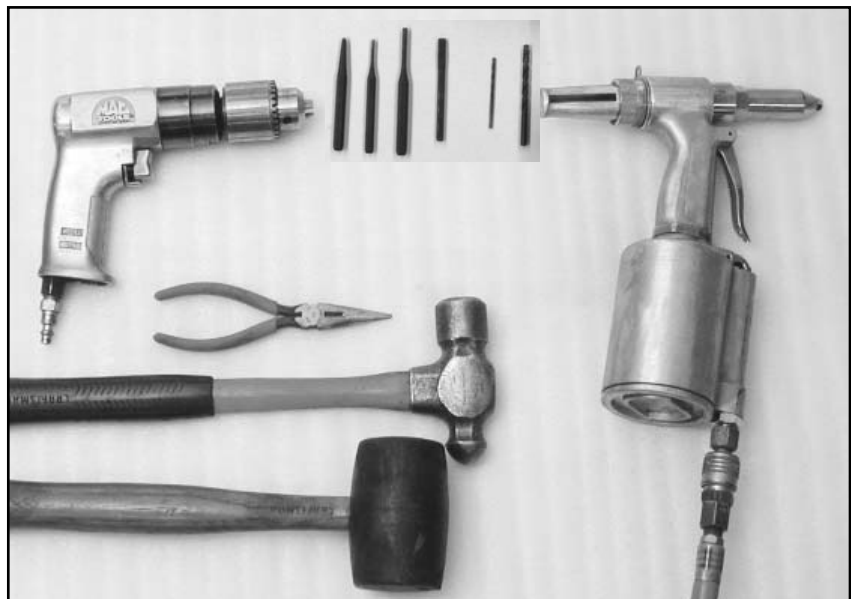

Figure 2

PREPARATION

1. Position the motorcycle securely on its side stand or a work stand.
2. Remove the Retainer Springs (spring puller.) Remove the bolt from the Hanger Clamp. Tap the joint where the muffler connects to the collector (hammer), then remove the muffler from the collector.

INSTALLATION

1.Center punch rivet centers at the outlet end of the muffler. (Center punch and Hammer.) **Figure 3.**

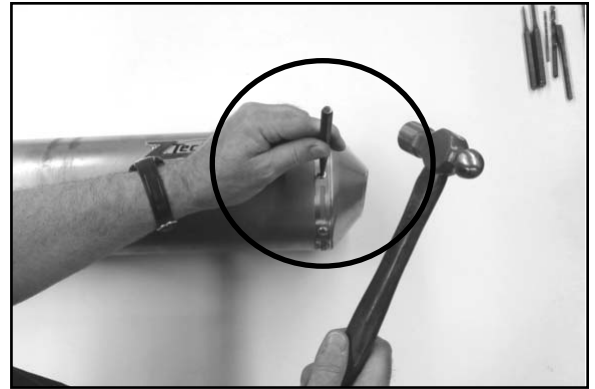

Figure 3

2. Drill heads off rivets. (Drill and Rivet Removal or Drill Bits.) **Figure 4.**



Figure 4

3. Push rivets into muffler. (Drift, 3/16" shank and Hammer.) **Figure 5.**

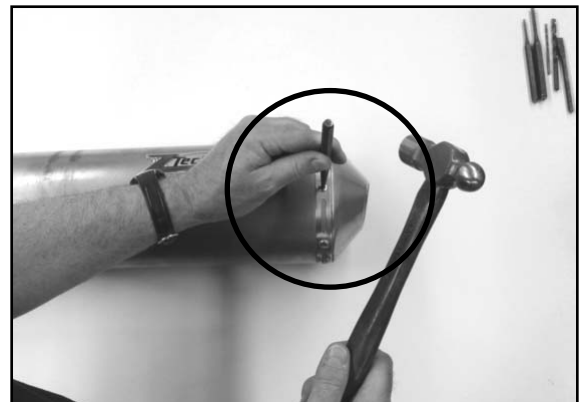

Figure 5

4. Using the 1/8" Drift from inside the rivet holes, start pushing the end cap out of the muffler can. **Figure 6.**

5. Once the Drift is no longer effective, use the Cold Chisel to push the end cap completely out of the muffler can. **Figure 6.**

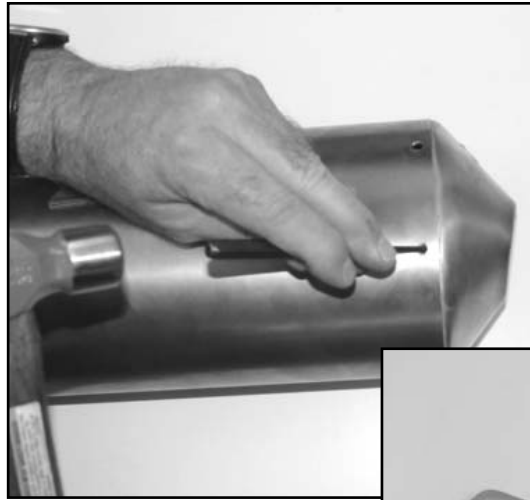

Figure 6

Figure 7

6. Pull the old packing from the muffler can (Needle Nose Pliers). **Figure 7.**

7. Insert new muffler packing.

- a) leave plastic wrap and core tube in place
- b) insert packing into cannister while you pull back on plastic wrap, packing is tight, work it in.
- c) pull core tube out after packing is completely in **Figure 8a,b,c.**

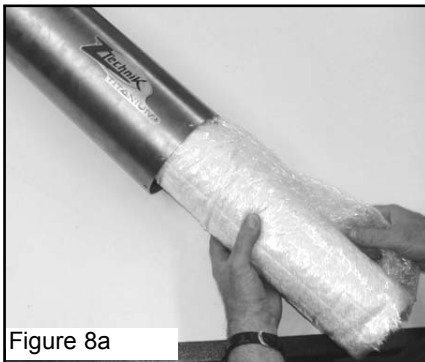

Figure 8a



Figure 8b



Figure 8c

8. Reinstall the end cap. Make certain the holes align. (If necessary use a Rubber Mallet). Figure 9.

9. Identify short end of strap. Start rivot with short end positioned at lower hole location as shown in Figure 10. Rivot first postion. (Air power pop rivot tool.)

10. Continue adding rivets in sequence from the first one.

11. Reinstall the muffler. Make sure there are no leaks.

12. Leaks will dramatically shorten the life of the muffler packing. Fix all leaks before riding.

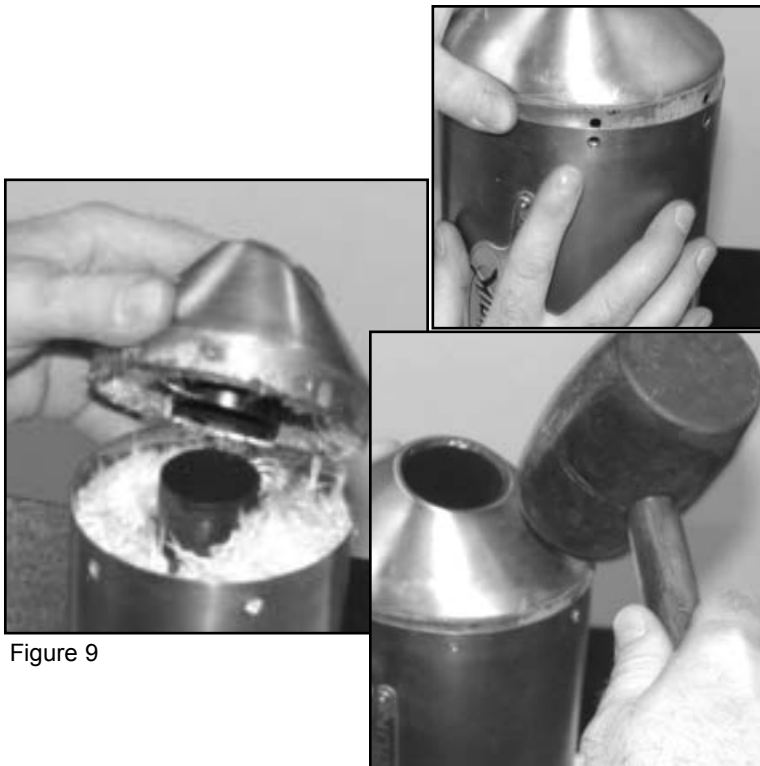

Figure 9

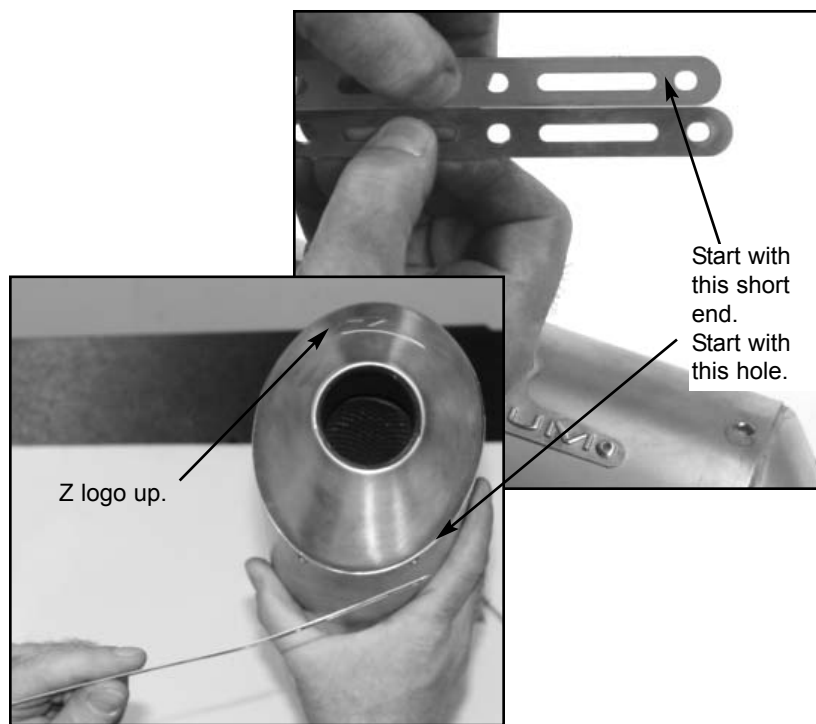

Figure 10

MAINTENANCE

Repack the mufflers at 6000 mile (10,000 km) intervals. Discoloration can be removed from the Exhaust System with a quality metal polish. Be sure to remove all polishing compound residue from the Exhaust System before running the engine.