

### PARTS LIST

<u>Index</u>	<u>Description</u>		<u>Qty.</u>
	Trunk Rack		1
	Drill Template		1
<b>BAG No. 372</b>			
3	Screw, Hex Flange M8 x 16	50-571018-000	3
4	Nut, Whizlok M12 - 1.75	42-433050-000	1
5	Washer, rubber 1" OD x .50 ID x .125	75-762017-000	2
6	Washer, Flat Chrome	49-490560-000	3
7	Washer, Rubber 1" OD x .375 ID	75-762019-000	6
<b>BAG No. 560</b>			
	Wire Loom	80-830105-000	1
	Scotchlock Connector	80-830103-000	4
	Tie Wrap	44-448723-000	1



### Tools Needed:

Scissors (for template)  
Cellophane Tape  
5/8" Hole Saw with Pilot Drill  
Socket, 10mm, with Wrench  
Wrench, 18mm  
Torque Wrench  
Motorcycle Service Manual (for reference)

### Tools for Wiring LED Light:

Socket, 10mm, with Wrench  
Small Flat Blade Screw Driver  
T30 Torx  
Pliers  
Electrical Tape  
Hand Drill with 3/8" Drill Bit

**Attention:** Before proceeding with the installation carefully read the instructions and consider whether one possesses the necessary technical skills and workshop tools to complete the installation properly. Otherwise, any BMW Motorcycle Retailer will be glad to install this accessory.

**Note:** To drill the mounting holes in your R1200CL Trunk Rack use the enclosed template for a drilling guide.

### PREPARATION

1. Place the motorcycle securely on its center stand or work stand.
2. Locate the Drill Template (form No.10-117742-000) and carefully follow the drilling Instructions that follow. **Do not attempt to drill the holes without a Drill Template.**

### DRILLING INSTRUCTIONS TO USE ALONG WITH THE DRILL TEMPLATE

1. Cut out large template along **SOLID** line.
2. Crease template with fingernail along 4.75" dashed lines.
3. Line up the template against the backrest pad. Line up the creases with those in the trunklid. **(1) The Rondel will align with the circle in the template.**
4. Smooth the template and tape positions marked.
5. Drill 1/8" or 3mm pilot hole normal to the surface (as illustrated on the template) at the positions shown.
6. Open the pilot hole to 5/8" or 16mm with a hole saw.

## INSTALLATION OF RACK

1. Sort the rubber washers. You should have 2 washers with an ID of .50" and 6 washers with an ID of .375".
2. Install one rubber washer .50 ID onto the threaded leg of the rack. Figure 1.
3. Install one rubber washer .375" ID onto each of the remaining legs. Figure 2.
4. First insert the threaded foot into the lid, and while pushing down to compress the rubber washer you will be able to insert the other three legs. Adjust the holes with a round file if needed.
5. From the inside of the lid you can place the other rubber washers on the appropriate legs. The plastic lid will be sandwiched between the washers.
6. Install the steel washers along with the 8mm screws on the 3 legs with the .375 washers. **Be sure not to pinch the steel washer between the screw head and the stand-off.**
7. Install the M12 whizlok nut onto the threaded leg.
8. Tighten all fasteners to 5 ft-lbs (7Nm). When properly installed they are engineered to *bottom-out* leaving the correct gap so as not to crush the plastic lid.

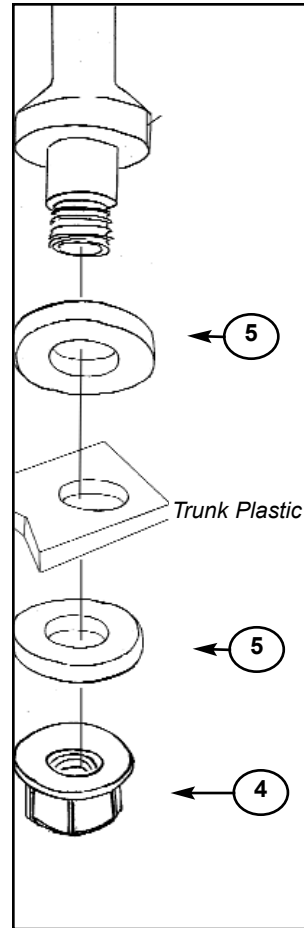

Figure 1.

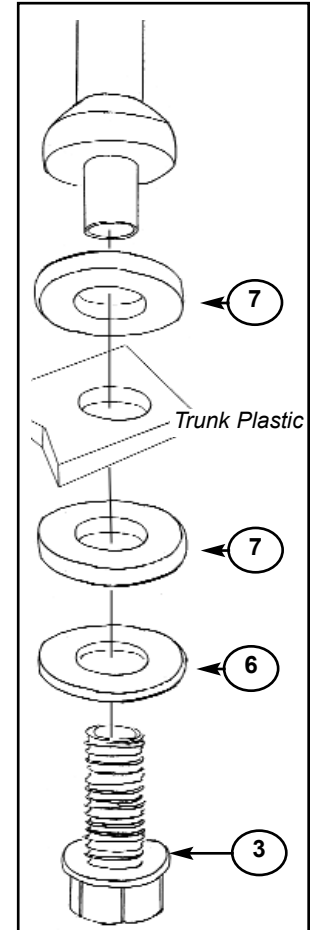

Figure 2.



## Wiring the Brake Light in the Z9070 Trunk Rack

### PREPARATION

1. Retain all fasteners as they will be re-used.
2. Remove the seats (Socket, 10mm)
3. If the seats are heated be sure to disconnect the heater wires.
4. Remove the liner inside the Trunk, it hooks around the latches for the top. (Flat Blade Screw Driver) **Figure 1.**
5. Remove the Trunk, four screws in the floor of the Trunk (T30 Torx) **Figure 2.**
6. Remove the Trunk platform (T30 Torx) **Figure 3.**
7. Remove the Antenna, if installed, and let hang by its cable. (T30 Torx) **Figure 3.**

### INSTALLATION OF WIRE HARNESS

1. Connect the **Gray Wire from the Harness to the Gray w/Yellow** at the Tail Light connector (Scotchlok and Pliers) **Figure 2.**
2. Connect the **Brown Wire from the Harness to the Brown wire** at the Tail Light Connector (Scotchlok and Pliers) **Figure 4.**
3. In the left corner secure Wire Harness with Tie Wrap. **Figure 4A.**

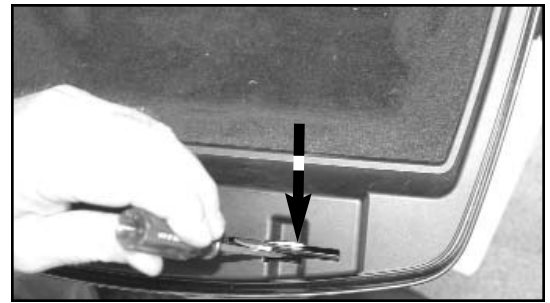

Figure 1



Figure 2



Figure 3



Figure 4

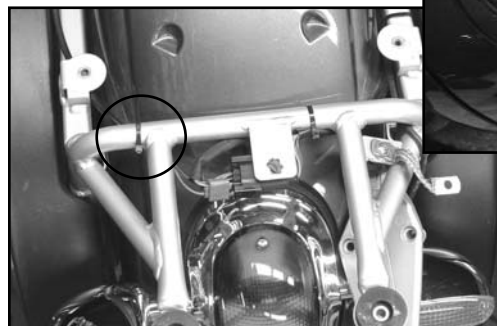

Figure 4A

3. Re-install the Trunk Platform and the Antenna. (T30 Torx) **Figure 4.**

4. Route the Harness along the left side of the fender. **Figure 5.**

5. Drill a 3/8" diameter hole in the Trunk as illustrated. (Drill, Drill Bit) **Figure 6.**

6. At the motorcycle, insert the Harness into the 3/8" hole and reinstall the Trunk.

7. Install the Grommet on the Harness around the hole in the Trunk.

8. Adjust the Harness so it reaches the wires from the Brake Light.

9. Connect the Gray Wire from the Harness to the Red Wire from the Brake Light. (Scotchlok and Pliers) **Figure 7.**

10. Connect the Brown Wire from the Harness to the White Wire from the Brake Light. (Scotchlok and Pliers)

11. Test the Brake Light. If it does not work check the wiring connections.

12. Tape the wire harness to the trunk. Close Lid of Trunk and check that wires clear hindge. (Electrical Tape) **Figure 8.**

13. Reinstall the Trunk liner and Seats.



Figure 4

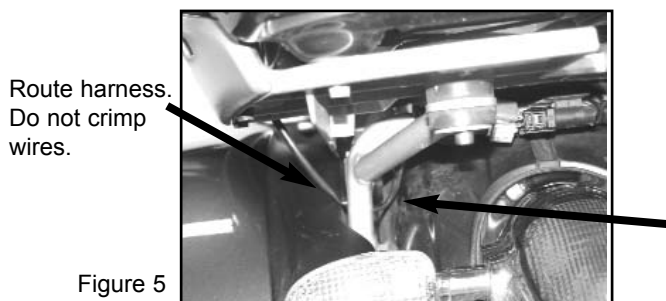

Figure 5



Figure 6

Curve wire like pictured to prevent wire from getting caught in lid.



Figure 8

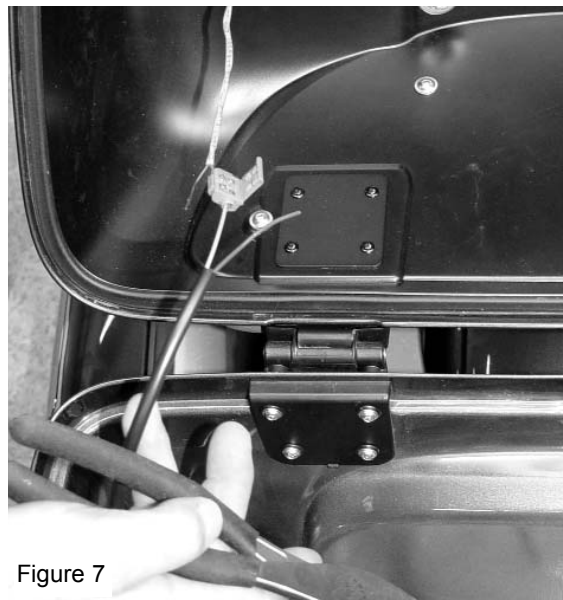

Figure 7